

Technical data sheet

Product features



Blast chiller/freezer 10x GN 2/1 TouchScreen stainless steel 400 V right door

Model	SAP Code	00009366
--------------	-----------------	----------



- Shock cooling cycle kg / min (+3 ° C): 70/90
- Shock freeze cycle kg / min (-18 ° C): 50/240
- Maximum device temperature [°C]: -40
- Probe: 4-points
- Insulation thickness [mm]: 80
- Control type: Touchscreen
- Display size: 9"
- User programmable cycles: Yes
- Thaving cycle: Yes

SAP Code	00009366	Number of GN / EN	10
Net Width [mm]	790	GN / EN size in device	GN 2/1
Net Depth [mm]	839	GN device depth	65
Net Height [mm]	1650	Shock cooling cycle kg / min (+3 ° C)	70/90
Net Weight [kg]	190.00	Shock freeze cycle kg / min (-18 ° C)	50/240
Power electric [kW]	2.390	Control type	Touchscreen
Loading	400 V / 3N - 50 Hz		

Technical data sheet

Technical drawing



Blast chiller/freezer 10x GN 2/1 TouchScreen stainless steel 400 V right door

Model

SAP Code

00009366

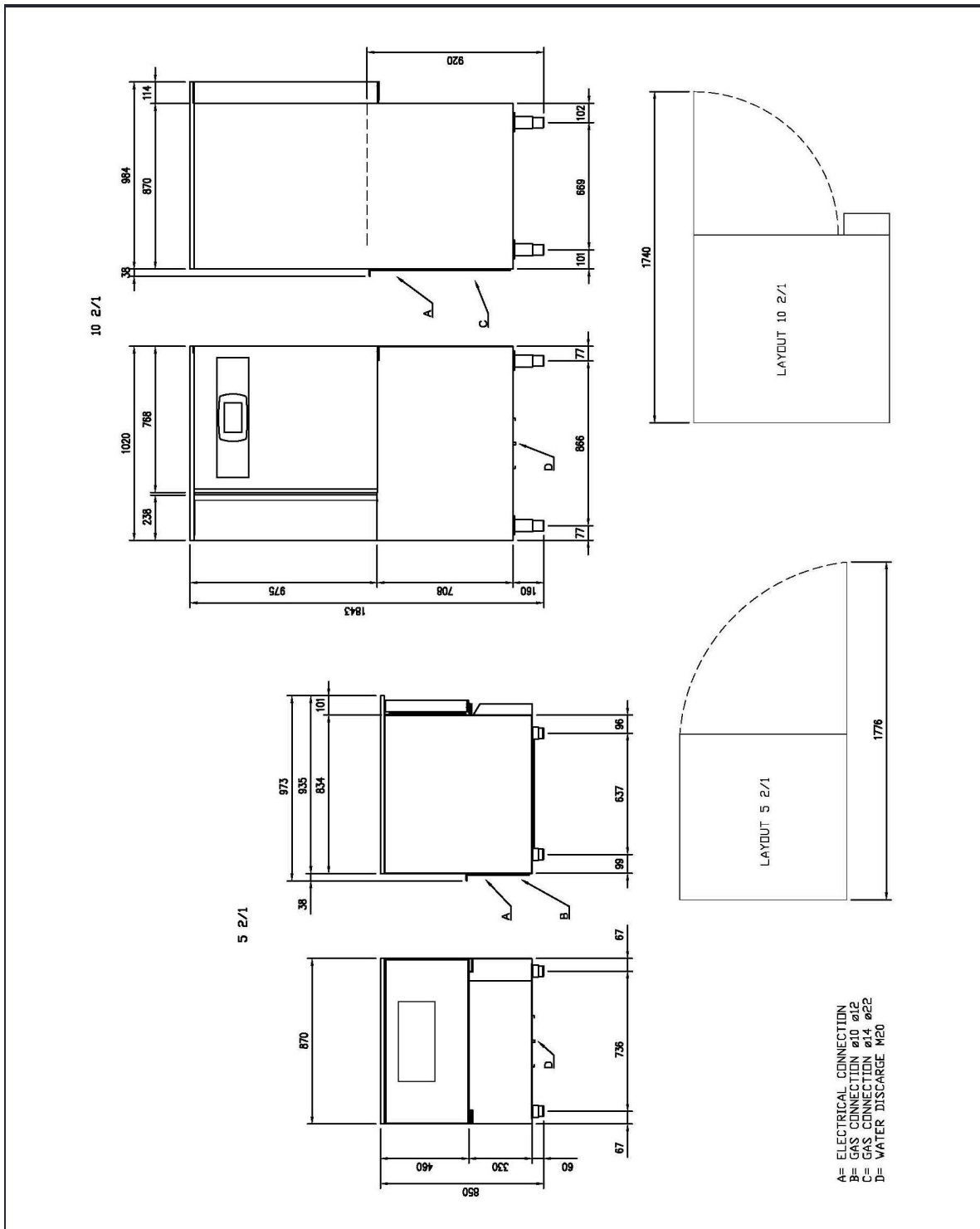

Technical data sheet

Product benefits



Blast chiller/freezer 10x GN 2/1 TouchScreen stainless steel 400 V right door

Model

SAP Code

00009366

1

Stainless steel body and interior

endurance
hygiene

- thanks to the all stainless steel construction it is very easy to maintain and thus saves costs
- meeting hygiene standards

2

Monitoring of HACCP parameters

easy registration of all necessary parameters

- hassle-free proof of proper food handling in the event of an inspection

3

Multipoint probe

precise monitoring of the cooling/freezing temperature

- food safety is better ensured thanks to the probe
- saves energy and time by stopping cooling/freezing when temperature is reached

4

Thawing

readiness of frozen food for processing on time

- time saving
- controlled food handling

Technical data sheet

Technical parameters



Blast chiller/freezer 10x GN 2/1 TouchScreen stainless steel 400 V right door

Model

SAP Code

00009366

1. SAP Code:

00009366

2. Net Width [mm]:

790

3. Net Depth [mm]:

839

4. Net Height [mm]:

1650

5. Net Weight [kg]:

190.00

6. Gross Width [mm]:

846

7. Gross depth [mm]:

860

8. Gross Height [mm]:

1780

9. Gross Weight [kg]:

248.60

10. Device type:

Electric unit

11. Material:

AISI 304

12. Exterior color of the device:

Stainless steel

13. Opening of device:

Hinges on the right

14. Power electric [kW]:

2.390

15. Loading:

400 V / 3N - 50 Hz

16. Control type:

Touchscreen

17. Display size:

9"

18. Refrigerant:

R452a

19. Number of GN / EN:

10

20. GN / EN size in device:

GN 2/1

21. GN device depth:

65

22. Maximum device temperature [°C]:

-40

23. Shock freeze cycle kg / min (-18 ° C):

50/240

24. Shock cooling cycle kg / min (+3 ° C):

70/90

25. Insulation thickness [mm]:

80

26. Long-term cooling function:

Yes

27. Longterm freezing function:

Yes

28. Probe:

4-points

Technical data sheet

Technical parameters



Blast chiller/freezer 10x GN 2/1 TouchScreen stainless steel 400 V right door

Model

SAP Code

00009366

29. Self-diagnostics:

Yes

30. Interior lighting:

Yes

31. HACCP:

Yes

32. Filter:

Removable

33. Thaving cycle:

Yes

34. User programmable cycles:

Yes

35. USB port:

Yes, for HACCP and firmware update

36. Castors:

Optional

37. Real time monitoring paramaters:

Energy consumption, Chamber temperature, Probe temperature, Graph with the course of temperature and consumption

38. Cross-section of conductors CU [mm²]:

1

- Výkon (kW): 3,7-5 (230 V); 6,4-8,7 (400 V)